

Slide [4] into [8] ensuring that the two "legs" on [4] slide inside the slots on [8] as shown in the pictures below.

Step 5.

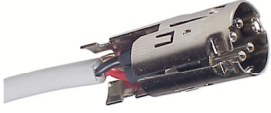

Push [5] into [8] orienting them as shown in the diagram opposite.

Step 4.



Solder the stripped and tinned wires onto [5]

Step 3.



Slide [1] & [2] onto the cable, followed by [3] & [4]

Step 2.



Push [1] into [2].

Step 1.



Pin Housing orientation diagram. (Front View)

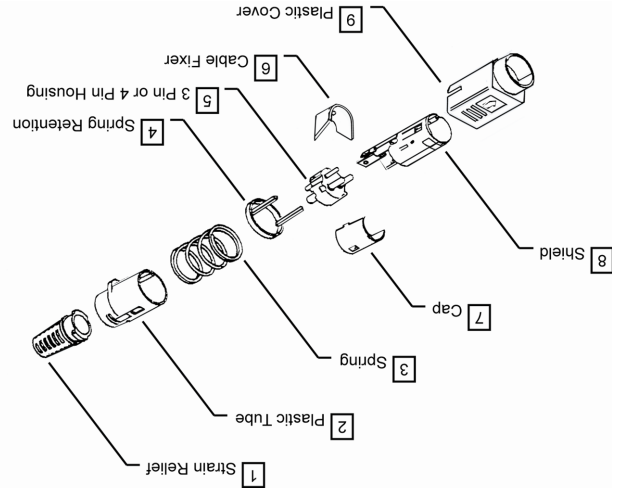

Exploded view.

Step 6

Place [6] onto [8] as shown the top picture ensuring that the dimple in [6] is located in the hole in [8]. Then crimp [6] to lock the cable firmly to the shield.

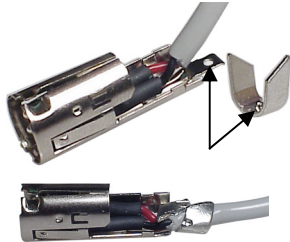

Step 7

Place [7] on top of [8] and slide [3] over the top of the assembly.



Step 8

Slide [1] + [2] (joined together in step #1) over [8]



Step 9

Slide [9] over the end of the assembly.



K3679 Series Quick Lock Plug Assembly Instructions

